

Elfin

Collaborative Robot

The Elfin collaborative robot can be used in automated integrated production lines, assembly, picking, welding, grinding, spraying and other applications, and has been exported to more than 100 countries and regions. It adopts a unique double-joint module design, where one motion module contains two joints to form a unique kinematic structure, which not only differs from most collaborative robots on the market, but also provides more flexibility when working.

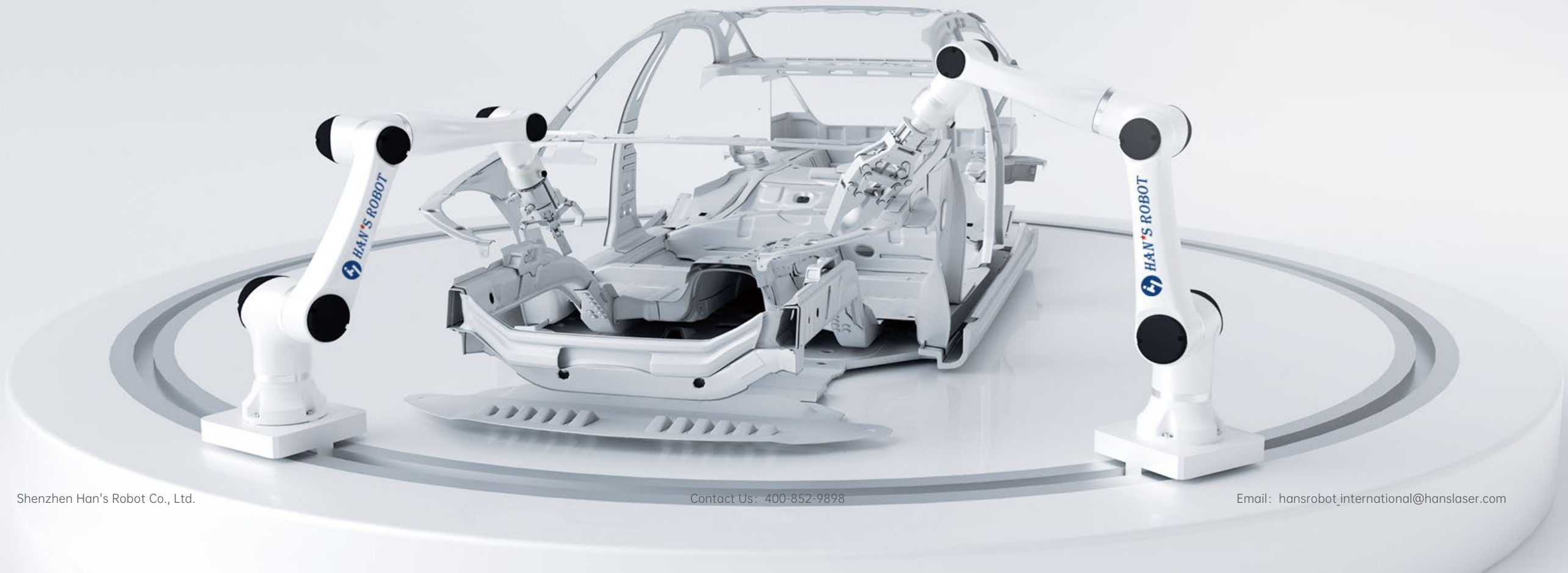

Elfin

Collaborative Robot

E03
590MM
3KG



E05
800MM
5KG



E05-L
950MM
3.5KG



E10
1000MM
10KG



E10-L
1300MM
8KG



E15
1300MM
15KG



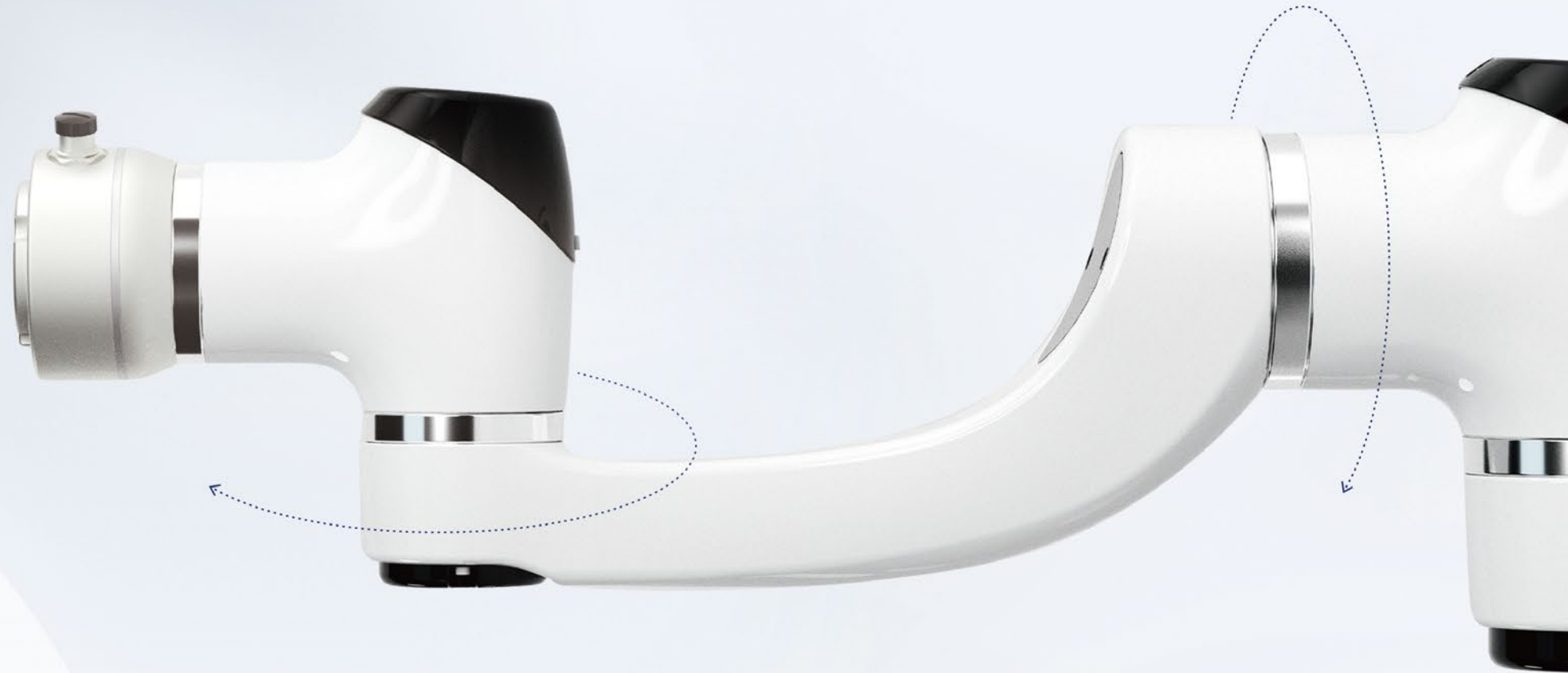

First dual-joint module design in China

The unique kinematic design enables the robot to have high flexibility. The highly integrated modular design minimizes the arm weight.



Optimized singularity

The unique arm design not only avoids the product homogeneity, but also reduces the singularity.



Highly flexible 6-DOF collaborative robot

The collaborative robot with 4/6-axis coaxial structure has almost reached the flexibility of 7-DOF robots.



Modularity

All-in-one module of fully self-developed reducer, motor, encoder, drive and software.



Industries

Electronics Automotive Metal processing Renewable energy Education

Applications





Loading and unloading Assembly Picking and placing Welding
Palletizing Dispensing Inspecting



Tech Specs

Model	Weight	Payload	Reach	Power consumption	Joint range	Joint speed	Tool speed	Repeatability	Degree of freedom	End I/O port	Control box I/O port	I/O Source	Communication	Programming	IP classification	Collaborative operation	Main material	Working temperature	Power input	Cable
E03	18kg	3kg	590mm	100W typical application	±360°	J1-J4 180°/s J5-J6 200°/s	2m/s	±0.02mm	6	Digital input: 3 Digital output: 3 Analog input: 2	Digital input: 16 Digital output: 16 Analog input: 2 Analog output: 2	24V 2A	TCP/IP and Modbus	Graphical programming remote call interface	IP54	10 advanced security configuration functions	Aluminum alloy	0-50°C	200-240V AC, (Optional 110-240V AC) 50-60Hz	Cable to the control box: 5m cable to the teach pendant: 5m
E05	25kg	5kg	800mm	180W typical application		J1-J4 180°/s J5-J6 200°/s	3m/s	±0.02mm												
E05-L	26kg	3.5kg	950mm	180W typical application		J1-J4 180°/s J5-J6 200°/s	3m/s	±0.02mm												
E10	43kg	10kg	1000mm	350W typical application		J1-J2 100°/s J3-J4 150°/s J5-J6 180°/s	2m/s	±0.03mm												
E10-L	45kg	8kg	1300mm	350W typical application		J1-J2 100°/s J3-J4 150°/s J5-J6 180°/s	2.5m/s	±0.03mm												
E15	60kg	15kg	1300mm	600W typical application		J1-J2 80°/s J3-J4 120°/s J5-J6 150°/s	2m/s	±0.05mm												

Product Configuration

Configuration Instructions	Robot	Control Box	Teach Pendant	Cable	Applications	Control box	Mini Control Box (Optional)	Teach pendant
Standard		Standard control box	Standard teach pendant (Resolution 1024×800, screen size 10.4 inches)	5m	/			
Mini control box		Mini control box Power module(Optional)	Tablet teach pendant (Optional)	5m	Applied for automation equipment, AGV, mobile robots, etc.	Dimensions 445.2mm x 318.8mm x (360+176)mm Stand height 176mm Weight 18.5kg Power output 48V DC Working temperature 0~50°C Working Humidity 90% relative humidity (non-condensing) IP classification IP20	Dimensions 323x221x80(mm) Power Input DC30~60V I/O Source DC24V I/O Port Inputs 8 , Outputs 8 IP Classification IP20 Communication TCP/IP Modbus	Dimensions 327 mm x 230 mm x (45+22) mm Weight 2.7kg (include cable) Display 10.4" Resolution 1024 x 800 E-stop button 1 IP classification IP54

Elfin

Collaborative Robot

Drawing

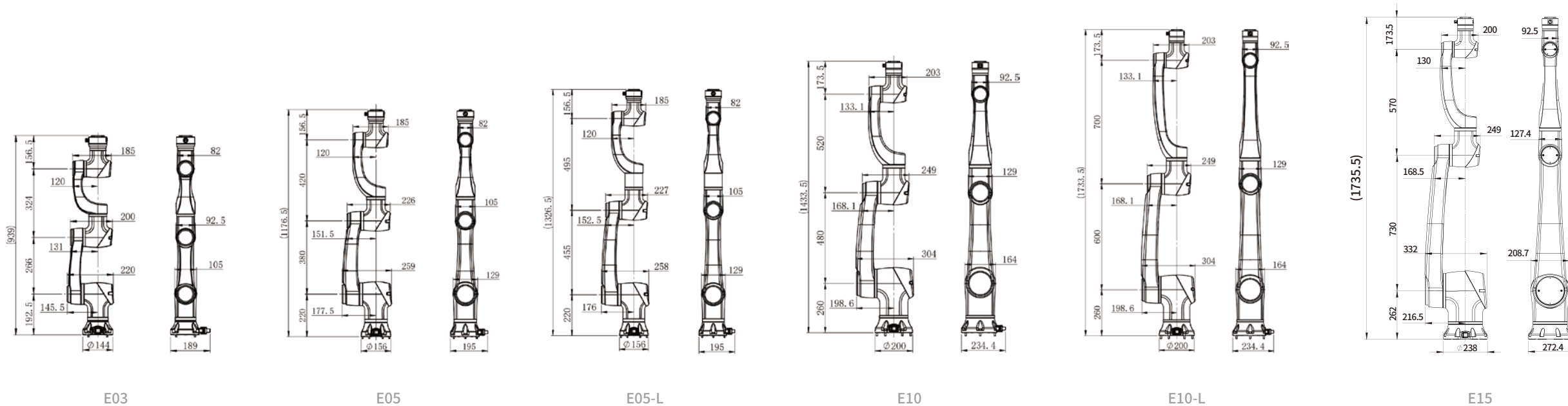



Serve Humanity With Robot Technology

Shenzhen Han's Robot Co., Ltd.

Headquarters address: 6/F, Building 3, Han's Laser
Global Intelligent Manufacturing Industry Base,
Bao'an District, Shenzhen

Contact Us: 400-852-9898

www.hansrobot.net

Email: hansrobot_international@hanslaser.com



www.facebook.com/shenzhenhansrobot
www.youtube.com/c/hansrobot
www.linkedin.com/company/hansrobot
www.twitter.com/Hans_Robot



Follow Us